

Sunrise Avenue

Govinda Agraharam, Sipcot-1, Hosur.



Call us: **+91 97919 37845 / 87540 44057**

www.sunriseavenuehosur.com

LAYOUT PLAN



Plot #	Sq. Ft.	Plot #	Sq. Ft.
82	1200	149	1200
83	1200	150	1200
84	1200	151	1200
85	1200	152	1200
86	1200	153	1200
87	1200	154	1200
88	1200	155	1200
89	1200	156	1200
90	1200	157	1200
91	1200	158	1200
92	1200	159	1200
93	1200	160	1200
94	1200	161	1200
95	1200	162	1200
96	2960	163	1200
97	1470	164	1200
98	1470	165	1200
99	1380	166	1200
100	1280	167	1000
101	1200	168	1000
102	1140	169	1200
103	1050	170	1600
104	990	171	1200
105	1200	172	1200
106	810	173	1200
107	1200	174	1200
108	1200	175	1200
109	1200	176	1200
110	1200	177	1200
111	1200	178	1200
112	1200	179	1200
113	1200	180	1200
114	1200	181	1200
115	1200	182	830
116	1200	183	1200
117	1200	184	1520
118	1200	185	1220
119	1200	186	2000
120	1200	187	1500
121	1200	188	1500
122	1200	189	1500
123	1200	190	1500
124	1200	191	1500
125	1200	192	1500
126	1200	193	1331.25
127	1200	194	1323.75
128	1200	195	1316.25
129	1200	196	1306
130	1200	197	1293.75
131	1200	198	1282.50
132	1200	199	1267.50
133	1200	200	954.50
134	1200	201-Part	820
135	1200	201-w/Ch	456.75
136	1200	202	1089
137	1200	203	1122
138	1200	204	1050

Total - 152142.25

EAST - FACING

LAND AREA : 30' X 40'-1200 Sq.Ft
BUILT AREA : 27'0" X 37'6"-1012 Sq.Ft



WEST - FACING

LAND AREA : 30' X 40'-1200 Sq.Ft
BUILT AREA : 27'0" X 37'6"-1012 Sq.Ft

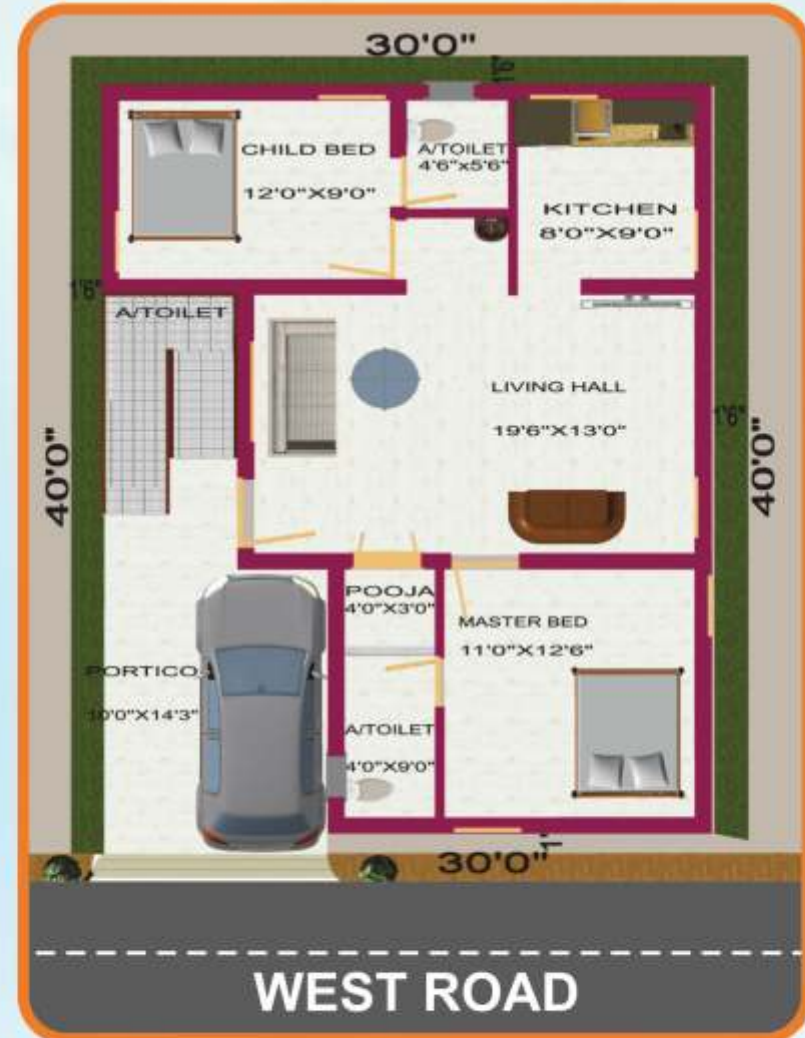

NORTH - FACING

LAND AREA : 30' X 40'-1200 Sq.Ft
BUILT AREA : 26'6" X 38'0"-1003 Sq.Ft



Sunrise Avenue

Govinda Agraharam, Sipcot - I, Hosur.
www.sunriseavenuehosur.com

SPECIFICATIONS

1. FLOORING

- Branded vitrified tiles for living, Dining, Bedrooms and Kitchen worth ₹ 45/- per Sq. Ft. The flooring in toilets will be laid with elegant looking ceramic tiles worth ₹ 40/- per Sq. Ft.

2. WALL TILING

- Kitchen will be designed with ceramic wall tiles for 2 feet above the platform worth ₹ 30/- per Sq. Ft.
- Toilet will have ceramic wall tiles for 7 feet height.

Note: Brand, Size and Colour of tiles will be builders choice based on bulk availability.

3. KITCHEN

- Black granite of size 2 feet width will be provided.
- Stainless sink will be provided.
- Kadappa stone shelf for about 4 feet width will be provided.

4. DOORS / WINDOWS

- Main door frame and door of Vannai wood exotically styled adding elegance to your entrance.
- Window frames and shutters are made up good quality UPVC windows.
- PVC doors for bathroom.
- One 3*4 size window per bedroom.
- One 5*4 size window in living hall.
- One 3*3 size window in kitchen.

5. PAINTING FINISHES

- Internal walls will be coated with putty and finished with asian emulsion paint.
- External walls will be finished with Supercem cement paint or equivalent.
- Main door will be Melamine finish .
- Internal ceiling will be finished with rough plastering and painted with white asian paint.

6. ELECTRICAL

- Finolex or equivalent cables.
- GM or equivalent switches.
- 15A plug points will be provided for Fridge, Washing Machine and Geyser in one toilet.
- TV cable will be provided in Living room.
- All internal services upto meter board only.

7. PLUMBING AND BATHROOM FITTINGS

- Hindustan Sanitaryware Or equivalent brand plumbing fittings
- Wash basin in any one bathroom.
- Wash basin in dining hall or living room (hall).
- Closets (Toilet) - 1 western and 1 Indian. White only.
- Shower fitting in any one bathroom.
- Water mixer fitting in any one bathroom and two taps in other bathroom.

8. OTHERS

- Water sump – Approx 4000 liters.
- Septic tank- Approx 4000 liters.
- PVC Overhead water tank 750 liters.



LOCATION MAP

Not to Scale

Sunrise Avenue



Distance & Drive Time

- 5 Minutes from 6 line Express National Highway
- 20 Minutes drive from Electronic City
- 10 Minutes Drive from Attibele
- Maharishi Vidya Mandir School, 600 m
- 15 Minutes Drive to Narayana Hrudayalaya Hospital
- Hosur International School , 3 Km
- 15 Minutes Drive to Hosur Bus Stand
- 10 Minutes Drive From The Chennai Silks
- 4 Km to Tittan Jewellery
- 5 Minutes Drive From St.Joseph School

Call us: **+91 97919 37845 / 87540 44057**

www.sunriseavenuehosur.com

* Terms and Conditions Apply